

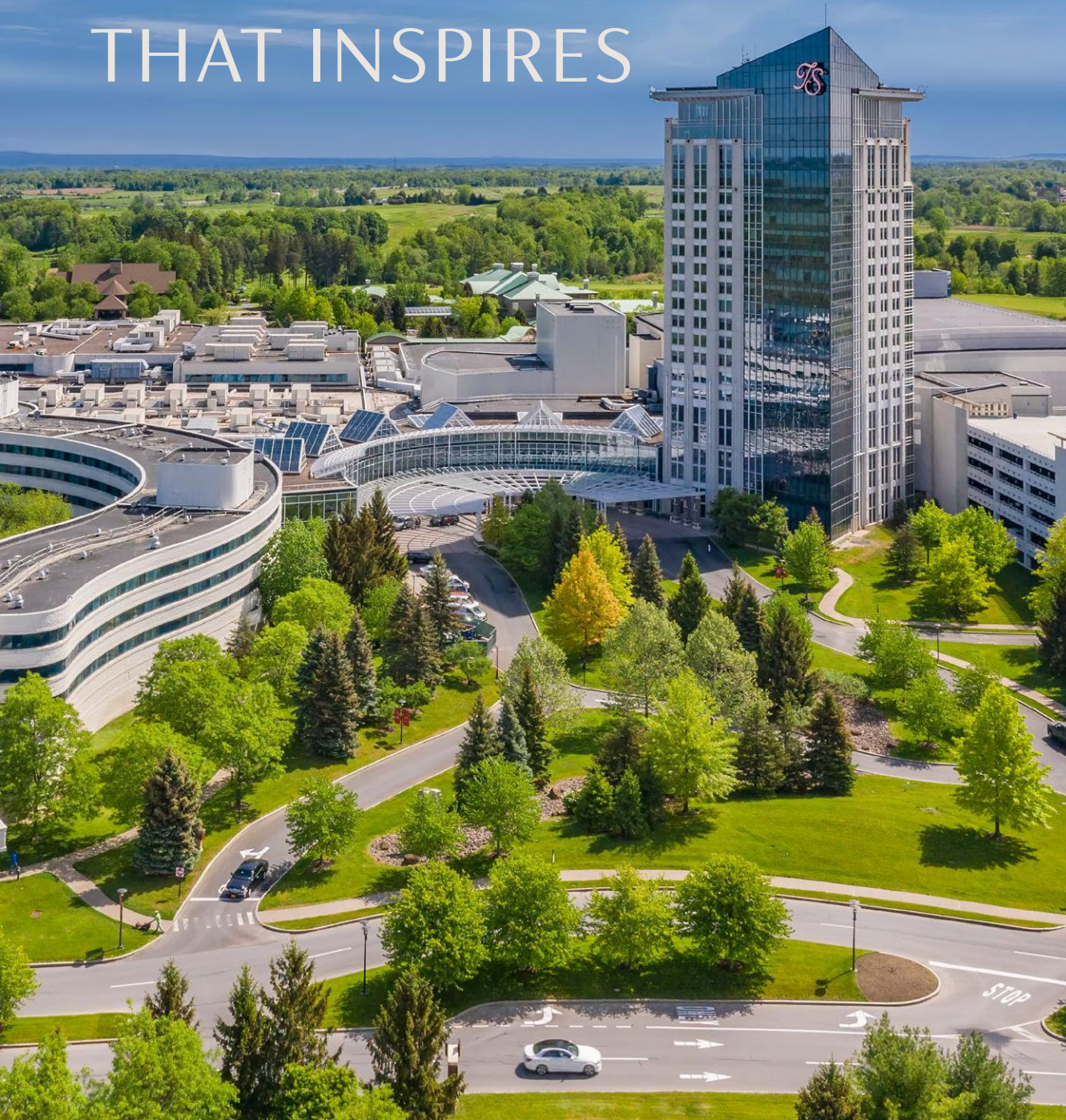

MEETINGS THAT —————
HIT BIG

A DESTINATION THAT INSPIRES



The natural beauty of Central New York's heartlands blends seamlessly with world-class amenities at Turning Stone Resort Casino, winner of the Forbes Travel Guide Four-Star Award and AAA Four Diamond Award.

- 125,000 square feet of meeting space
- 788 guest rooms, from comfortable and affordable to lavish and luxurious
- Flexible, contiguous rooms for general sessions and breakout sessions
- 20+ dining options, from fine dining to quick and convenient
- Two luxury spas for relaxation and rejuvenation
- Three award-winning golf courses
- 10+ nightlife options featuring live music, cocktails and more
- Centrally located — easy travel by air, car or rail



THE LODGE AT TURNING STONE

LODGING THAT ELEVATES

THE LODGE AT TURNING STONE

Our gorgeous woodland retreat offers elegant luxury suites with separate workspaces.

THE TOWER AT TURNING STONE

Contemporary, stylish rooms and suites with panoramic views — topped with the award-winning TS Steakhouse on the penthouse floor.

THE BROOK AT TURNING STONE

Located at the heart of the resort, The Brook offers rooms and suites with convenient access to meetings, dining and more.

SANDSTONE HOLLOW INN AT TURNING STONE

This relaxed, friendly inn is a short, complimentary shuttle ride from the main campus.

THE INN AT TURNING STONE

Comfortable, affordable rooms and a staff who make you feel welcome. You can also enjoy a complimentary breakfast and complimentary shuttle ride to the casino.

THE COVE AT SYLVAN BEACH

Stay lakeside in delightful, spacious 2- or 3-bedroom cottages — with lots of extra amenities. Open seasonally.



THE TOWER AT TURNING STONE

DINING THAT WOWS

Enjoy private dining for groups and indulge in culinary excellence at your choice of over 20 signature restaurants.

WILDFLOWERS

Honored with the AAA Four Diamond Award and the Forbes Travel Guide Four-Star Award, Wildflowers sets the standard for atmosphere and culinary excellence with locally sourced, seasonal dishes.

TS STEAKHOUSE

TS Steakhouse, located on the 21st floor of The Tower, features classic cuts, chops and cocktails with panoramic views, fine cigars and spirits.

PEACH BLOSSOM

Peach Blossom combines Chinese and Thai cuisine with variety, freshness, sweet and spicy flavors. Our chefs create artistic and succulent dishes that satisfy your palate and delight your eyes.

PINO BIANCO

Pino Bianco, located in the center of the resort, is an Italian-style restaurant where dinner is served up in a casual yet sophisticated setting.





NY REC & SOCIAL CLUB



SUSHI SUSHI



THE UPSTATE TAVERN

THE UPSTATE TAVERN

From local ingredients to local brews, the menu offers culinary creations that are time-honored, New York-inspired, and familiar American classics prepared from scratch.

7 KITCHENS

A station-style buffet with a robust menu to appeal to every palate. Choose from Asian, Italian, seafood, tacos, meats, the grill and desserts.

NY REC & SOCIAL CLUB

Unleash your competitive spirit, savor signature cocktails and win over your hunger. Epic eats, ranging from shareable snacks to gourmet delights, hit the spot every time.

THE FOOD HALL AT TURNING STONE

Stop in at the Food Hall for six unique dining options ranging from hot corned beef sandwiches to margherita pizza, General Tso's chicken, Philly burgers, fried chicken and shredded pork quesadillas.

SUSHI SUSHI

A variety of Sashimi, Nigiri and Maki rolls are handcrafted by our Sushi Chef — featuring his daily selection of the highest-quality fish and steaming Asian Noodles. Take a seat and enjoy the art of sushi making.

EMERALD RESTAURANT

Emerald serves casual fare in a comfortable, relaxed setting. Choose from a classic American menu ranging from breakfast to fresh salads, sandwiches, burgers and dinners, available for dine-in and takeout 24 hours a day.

TIN ROOSTER DANCEHALL & BBQ

At Tin Rooster, the pig is sacred, the beer is cold and the atmosphere is country Americana at its finest. Our BBQ features signature flavors that may start a finger-lickin' obsession.

OPALS CONFECTIONERY

Indulge in fresh hot coffee, a just baked muffin or house-made fudge at Opals. A tempting array of rich confections will satisfy your sweet tooth.

THE GRILLE AT SHENENDOAH

Grab a bite in this stone-and-cedar-style clubhouse. The Grille at Shenendoah features a full breakfast menu. Open seasonally with outdoor al fresco dining.

TOWER LOUNGE

Enjoy a vibrant atmosphere and a wonderful selection of cocktails and nosh-ready snacks.

THE LODGE LOUNGE

The bar provides panoramic views of the western sky overlooking The Great Lawn. This beautiful spot offers sunsets, spirits and savory spreads.

MEETING SPACES THAT IMPRESS



125,000 square feet of flexible meeting space, with unobstructed views for impactful general sessions and breakouts.

THE CONFERENCE CENTER

Large or small, your group will find the perfect fit in our Conference Center. There's plenty of room for keynotes, exhibits, seminars, meals, meetings and even company celebrations — all staffed by our consummate service professionals in a grand ballroom setting.

- 22,500+ sq. ft.
- State-of-the-art technology and in-house AV support
- Breakout meeting rooms with flexible configurations
- Accommodates banquets for up to 800 guests
- Ground-level load-in access
- Private registration desk

CYPRESS BALLROOM

A natural light-filled space that works exceptionally well for large meetings, elegant corporate celebrations and effective training events, The Cypress Ballroom is adjacent to The Event Center. Used as a single session or divided into as many as five breakout spaces, it is a versatile resource for any program.

- 5,700+ sq. ft.
- Flexible configuration
- Beautifully furnished



CYPRESS BALLROOM

THE SHOWROOM

Ideal for keynote addresses, The Showroom offers state-of-the-art lighting and sound, a luxurious bar and exceptionally comfortable theater seating.

- Stadium-style seating
- Accommodates up to 650 guests



THE SHOWROOM

THE EVENT CENTER

A truly majestic space, The Event Center offers a 30,000-square-foot exhibit floor that can be configured to match your most specific needs. It also includes the 19,000-square-foot Atrium provides an ideal setting for registration and other pre-function activities.

- Including the Atrium, 49,000+ sq.
- In-house public address system for the event floor
- In-floor power supply
- Can host up to 1,200 guests for dinner
- Accommodates up to 180 10x10' booths



THE EVENT CENTER



SHENENDOAH CLUBHOUSE



THE LODGE BOARDROOM

SHENENDOAH CLUBHOUSE

Quiet, beautiful, inspirational. The Clubhouse is a favorite setting for executive board retreats, incentive meetings and corporate celebrations. This one-of-a-kind meeting space is steps away from the main resort.

- 5,900 sq. ft. that can be used as a single session or three breakouts
- Expansive room with fireplace and balcony
- Convenient self-parking
- Outdoor patio
- Located adjacent to The Lodge at Turning Stone
- Picturesque fairway views

THE LODGE BOARDROOM

The Lodge Boardroom eclipses traditional meeting spaces by providing a serene space with private access to the scenic Great Lawn. The Boardroom is luxuriously furnished, fully loaded with high-tech amenities and expert staff ready to assist.

- Seats up to 14
- Executive leather chairs
- Extensive charging ports in the table
- Built-in telecommuting technology
- Large LCD video monitor
- Access to outdoor patio
- Automated black-out shades for enhanced presentation clarity

TOWER MEETING ROOMS

Perfect for small-group discussions, seminars and boardroom-style meetings, The Tower lends your gathering the right combination of intimacy, convenience and sophistication. These private, natural light-filled and fully equipped rooms serve as the ideal space for board meetings, show offices, small breakouts and intimate receptions.

- Seven boardroom-style meeting rooms from 400 to 900+ sq. ft. each
- Easy access to the parking garage, the hotels, Conference Center and dining

THE CONFERENCE CENTER

SPECIFICATIONS

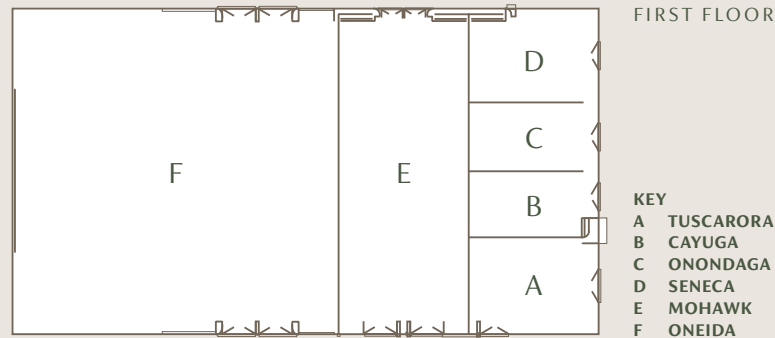

ROOM	DIMENSIONS	THEATER	CLASSROOM	BANQUET	SQ. FT.
Tuscarora	37'x55'	126	72	60	1,579
Cayuga	27'x51'	108	63	50	1,337
Onondaga	26'x51'	108	63	50	1,252
Seneca	33'x51'	126	72	60	1,609
Mohawk	116'x45'	540	270	230	5,212
Oneida	132'x101'	624	514	400	11,465
Combined	119'x196'	1,632	1,054	850	22,500

MINIMUM CEILING HEIGHT — 12 - 16 FEET

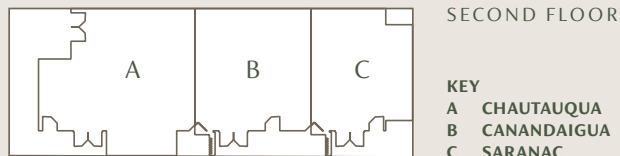

ROOM	DIMENSIONS	THEATER	CLASSROOM	BANQUET	SQ. FT.
Chautauqua	31'x32'	49	27	40	836
Canandaigua	25'x24'	40	27	30	618
Saranac	25'x21'	45	27	20	499
Combined	36'x80'	144	81	90	1,953

MINIMUM CEILING HEIGHT — 10 FEET

CYPRESS BALLROOM

SPECIFICATIONS

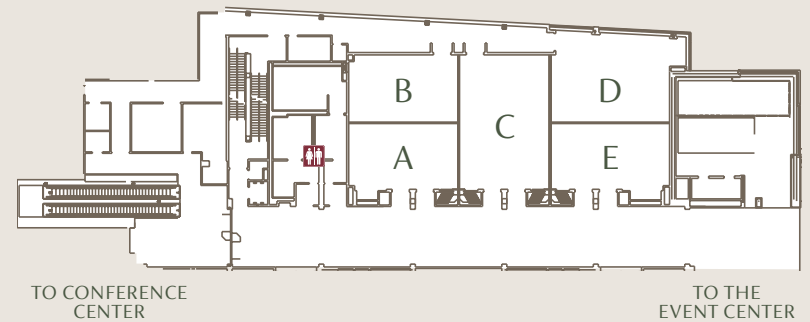

ROOM	DIMENSIONS	THEATER	CLASSROOM	BANQUET	SQ. FT.
Cypress A	23'x38'	50	36	40	933
Cypress B	23'x38'	60	36	30	893
Cypress C	47'x31'	126	72	60	1,509
Cypress D	23'x38'	72	57	40	1,346
Cypress E	23'x38'	50	42	40	1,024
Cypress A+B	47'x38'	126	84	60	1,826
Cypress D+E	56'x41'	180	108	90	2,370
Cypress Total	112'x56'	450	306	230	5,705

CEILING HEIGHT — 12 - 55 FEET

THE EVENT CENTER

SPECIFICATIONS



ROOM	SQ. FT.
The Event Center	29,868
Atrium	18,981
CEILING HEIGHT — 12 - 55 FEET	

SHENENDOAH CLUBHOUSE

SPECIFICATIONS

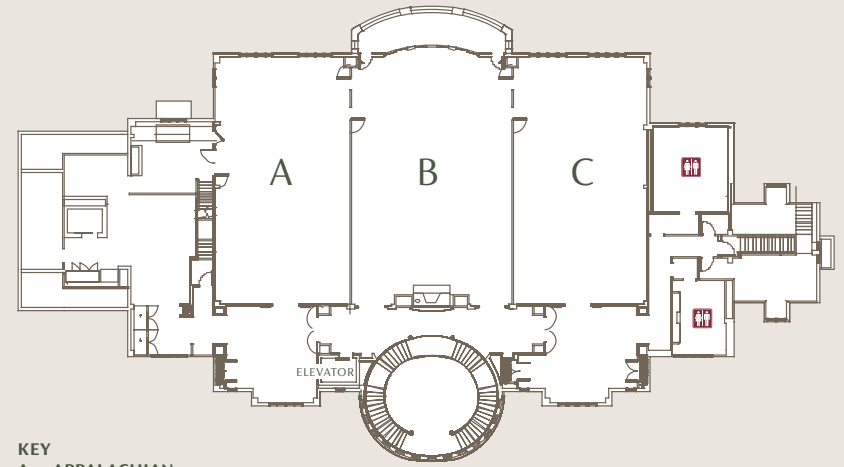

- KEY
A APPALACHIAN
B ADIRONDACK
C CATSKILL

ROOM	DIMENSIONS	THEATER	CLASSROOM	BANQUET	SQ. FT.
Appalachian	32'x58'	154	84	70	1,851
Adirondack	38'x58'	176	84	90	2,221
Catskill	32'x58'	154	84	70	1,830
Combined	58'x102'	414	216	230	5,902
MINIMUM CEILING HEIGHT — 10 FEET					

THE LODGE BOARDROOM

SPECIFICATIONS

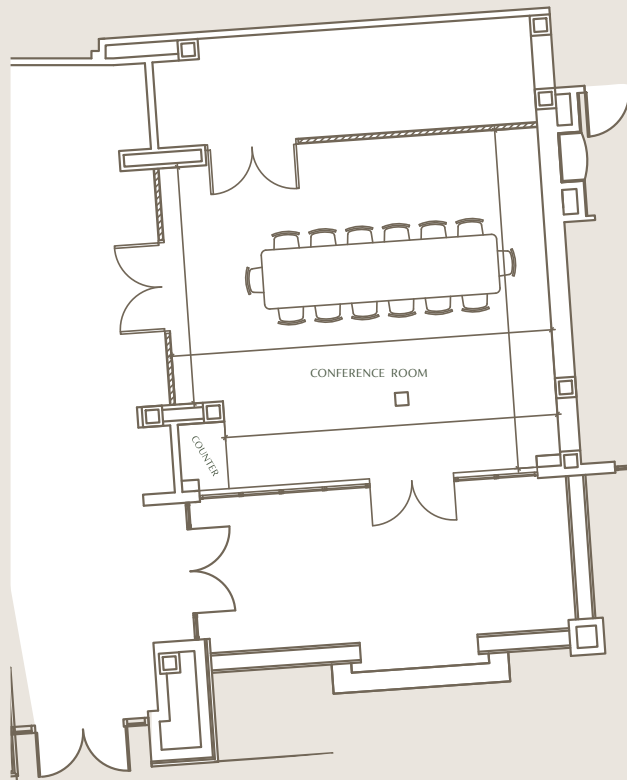

DIMENSIONS	CAPACITY	SQ. FT.
22'x25'	14	550
MINIMUM CEILING HEIGHT — 10 FEET		

THE TOWER MEETING ROOMS

SPECIFICATIONS

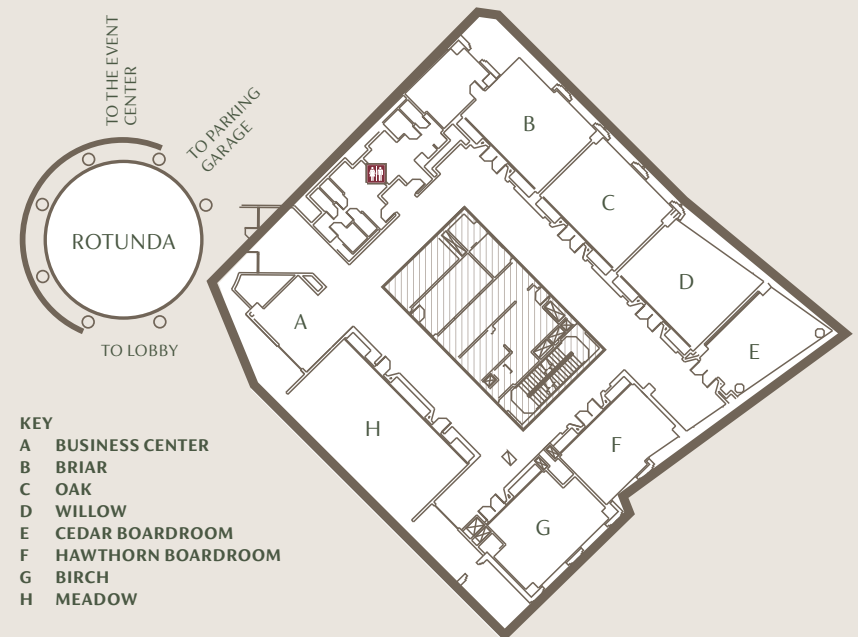

- KEY**
- A BUSINESS CENTER
 - B BRIAR
 - C OAK
 - D WILLOW
 - E CEDAR BOARDROOM
 - F HAWTHORN BOARDROOM
 - G BIRCH
 - H MEADOW

ROOM	DIMENSIONS	THEATER	CLASSROOM	BANQUET	SQ. FT.
Briar	23'x26'	50	22	30	581
Oak	23'x26'	46	24	30	571
Willow	26'x35'	46	24	30	587
Cedar	27'x19'	N/A	N/A	N/A	407
Hawthorn	19'x25'	N/A	N/A	N/A	459
Birch	22'x27'	34	18	20	513
Meadow	24'x43'	75	36	40	944
MINIMUM CEILING HEIGHT — 10 FEET					

AWARD-WINNING GOLF

An aerial photograph of a golf course. In the foreground, there are several large, irregular sand traps. A green fairway leads to a green with a white flag. In the middle ground, a large, white, two-story clubhouse with a dark roof and multiple chimneys is visible. The clubhouse is surrounded by trees with autumn foliage. In the background, a stream flows through the course, with a rocky waterfall in the lower right corner. The sky is a clear, bright blue.

- Three world-class and two executive courses
- The Sportsplex at Turning Stone is open all year for practice, lessons and more
- Group lessons available

ATUNYOTE

The parkland setting of Atunyote features vast stretches of open space, gently rolling hills, a stream of small waterfalls and several lakes. Walk the fairways that past PGA champions have walked.

SHENENDOAH

Experience 18 holes of PGA-level golf in a spectacular natural setting with wooded parkland holes and open pastures that capture the links feel. Designed, constructed and maintained to tour standards at more than 7,000 yards, the course offers conditions normally reserved for tour professionals.

KALUHYAT

Measuring in at just over 7,100 yards, Kaluhyat is ranked as a Top Casino Course by Golfweek. The course is marked by dramatic changes in elevation, with plateau settings offering seemingly endless views of the surrounding terrain. The course is a classic shot-maker's course, where accuracy and strategy are rewarded as much as length.

RELAXATION AND RECREATION



Ská:ná: THE SPA AT TURNING STONE

SPAS

- Ská:ná: The Spa at Turning Stone, awarded four stars by Forbes Travel Guide
- Áhsi' Day Spa

OUTDOOR RECREATION

SALMON ACRES

36 acres on the banks of the world-renowned Salmon River. This could well be the finest salmon fishing you'll ever experience.

SYLVAN BEACH SUPPLY CO.

Located on beautiful Oneida Lake, Sylvan Beach Supply Co. offers rentals of boats, kayaks, paddle boards, fishing gear, bikes and more.



SYLVAN BEACH SUPPLY CO.

NIGHTLIFE AT EXIT 33

From live rock bands to luxurious lounges, we've got it all when it's time for your team to kick back. Available for private events or eclectic breakout meetings.

NY REC & SOCIAL CLUB

Our new social club experience. Come for good times, great games, epic eats and signature cocktails.

ATRIUM BAR

The perfect spot for a meet-up or casual sit-and-sip, serving specialty cocktails, crafted drinks and imported and domestic beers.

TIN ROOSTER DANCEHALL & BBQ

Country and Americana at its finest. Giddy up!

TURQUOISE TIGER

A 1940s Film Noir-inspired lounge.

THE GIG

Your neighborhood rock 'n' roll joint — right down the hall from your meeting.

EXIT 33 COURTYARD

Located right outside all the nightlife happenings, featuring patio seating, a fire pit, twinkling lights and a full bar. Open seasonally.



NY REC & SOCIAL CLUB



TIN ROOSTER DANCEHALL & BBQ

EXIT 33

SPECIFICATIONS

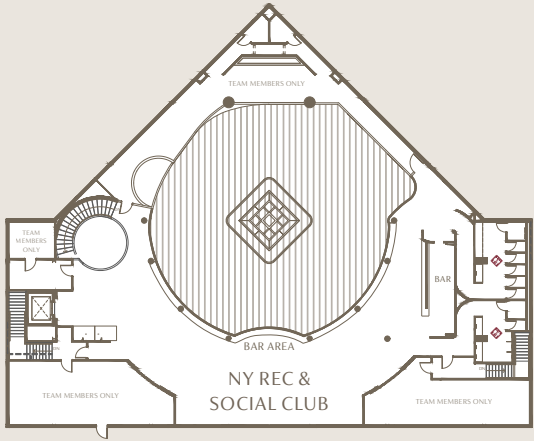
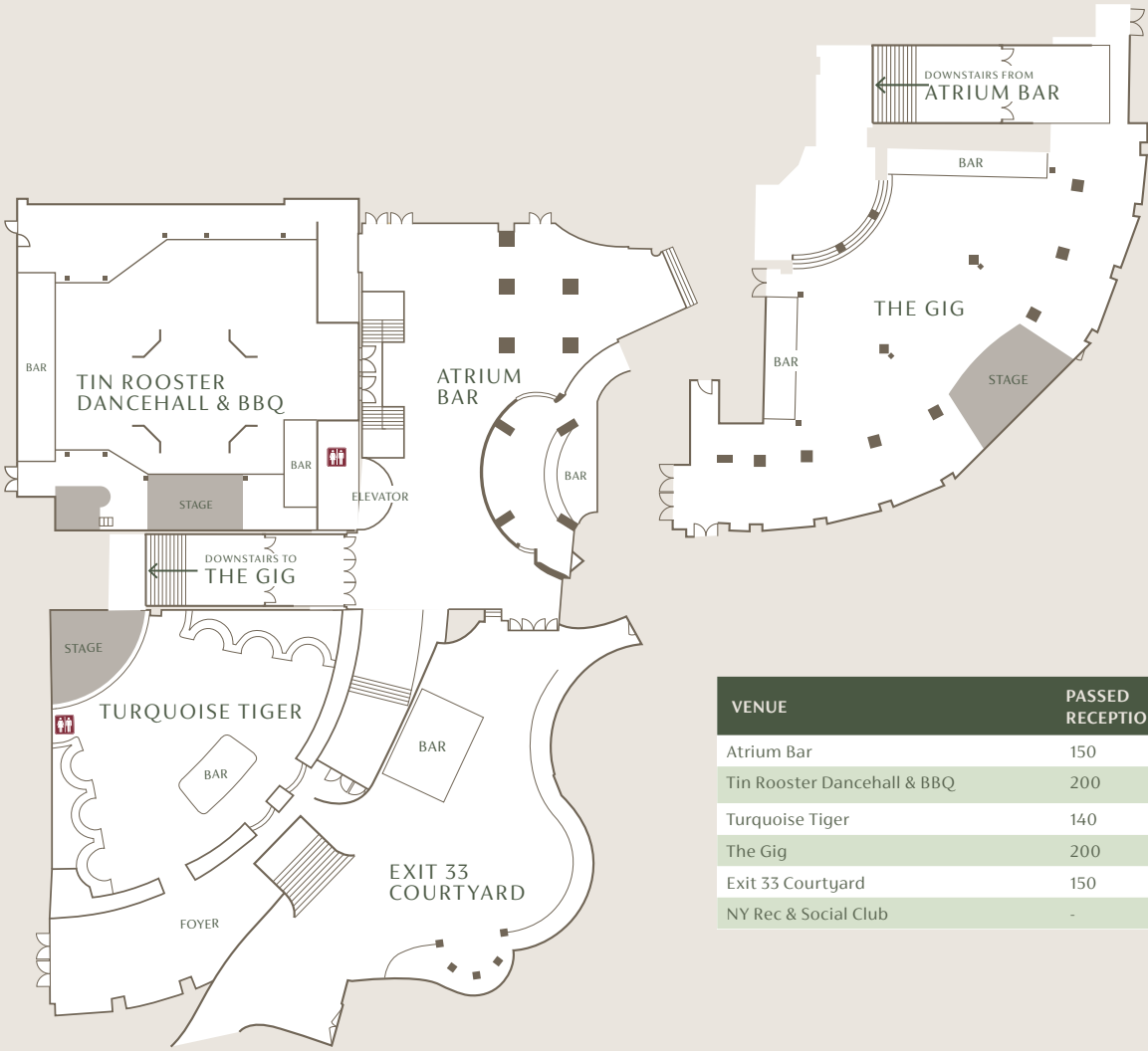

VENUE	PASSED RECEPTION	STATION RECEPTION	BANQUET
Atrium Bar	150	100	90
Tin Rooster Dancehall & BBQ	200	200	138
Turquoise Tiger	140	120	-
The Gig	200	200	100
Exit 33 Courtyard	150	100	50
NY Rec & Social Club	-	101	-

PROPERTY MAPS

OVERALL SPECIFICATIONS

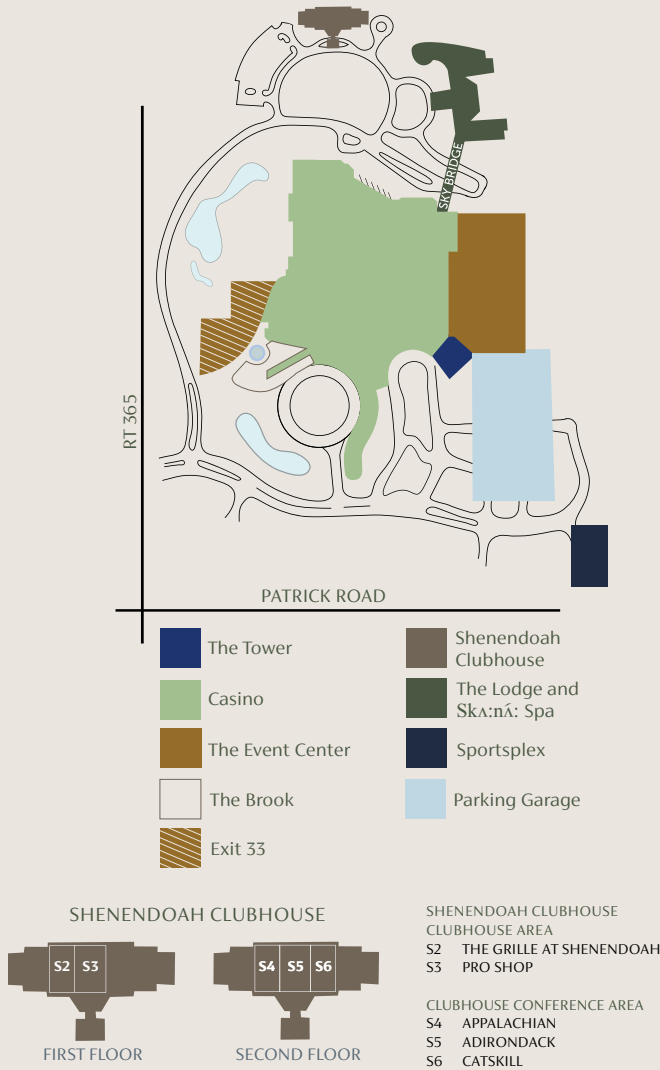

DETAIL SPECIFICATIONS



ACCOMMODATIONS

- A1 ELEVATOR TO THE BROOK
- A2 THE BROOK AND THE TOWER FRONT DESK
- A3 THE LODGE FRONT DESK

CONVENTION CENTER

- M1 SARANAC
- M2 CANANDAIGUA
- M3 CHAUTAUQUA
- M4 TUSCARORA
- M5 CAYUGA
- M6 ONONDAGA
- M7 SENECA
- M8 MOHAWK
- M9 ONEIDA

ENTERTAINMENT

- E1 THE EVENT CENTER
- E2 THE SHOWROOM
- E3 NY REC & SOCIAL CLUB
- E4 TIN ROOSTER DANCEHALL & BBQ
- E5 THE GIG
- E6 TURQUOISE TIGER

GAMING

- C1 TS REWARDS DESK
- C2 GOLDEN DRAGON
- C3 KENO
- C4 CASINO GAMING FLOOR
- C5 CASINO CASHIER
- C6 POKER ROOM
- C7 CASINO BLU
- C8 HIGH STAKES BINGO
- C9 GAMING COMMISSION
- C10 TS SPORTS
- C11 THE PARLOR - MEMBERS ONLY

RECREATION

- G1 THE BROOK POOL
- G2 THE TOWER FITNESS CLUB & POOL

RESTAURANTS, BARS AND LOUNGES

- R1 ATRIUM BAR
- R2 PEACH BLOSSOM
- R3 THE FOOD HALL
- R4 BAR PINO
- R5 PINO BIANCO
- R6 SUSHI SUSHI
- R7 EMERALD RESTAURANT
- R8 OPALS CONFECTIONERY
- R9 MOTIF BAR & LOUNGE
- R10 7 KITCHENS
- R11 THE UPSTATE TAVERN
- R12 TS STEAKHOUSE
- R13 BAR BLU
- R14 WILDFLOWERS
- R15 THE LODGE BAR
- R16 TOWER LOUNGE
- R17 NY REC & SOCIAL CLUB
- R18 TIN ROOSTER DANCEHALL & BBQ

RETAIL

- S1 ONEIDA HERITAGE
- S2 POLLY COOPER
- S3 JUNIPER
- S4 REVEL SUPPLY
- S5 WILLOW & JAYE
- S6 THE KIOSK
- S7 SMOKIN' 2
- S8 THE GENERAL STORE
- S9 MR. SHOP

SPA

- L1 ÁHSI' DAY SPA
- L2 Skl:ná: SPA

CONVENTION CENTER

- T1 BUSINESS CENTER
- T2 MEADOW
- T3 BIRCH
- T4 HAWTHORN
- T5 CEDAR
- T6 WILLOW
- T7 OAK
- T8 BRIAR

ENTERTAINMENT

- T9 THE EVENT CENTER BOX OFFICE
- T10 THE EVENT CENTER

CYPRESS CONFERENCE AREA

- T11 CYPRESS A
- T12 CYPRESS B
- T13 CYPRESS C
- T14 CYPRESS D
- T15 CYPRESS E

THE EVENT CENTER SECOND FLOOR

